

# New Jersey Semi-Conductor Products, Inc.

20 STERN AVE.  
 SPRINGFIELD, NEW JERSEY 07081  
 U.S.A.

TELEPHONE: (201) 376-2922  
 (212) 227-6005  
 FAX: (201) 376-8960

## SWITCHING DIODE

4] TYPE No.	3] PIV (V)	RECOVERY TIME TEST CONDITIONS				MIN. FORWARD CURRENT at 25°C				MAX. REVERSE CURRENT				CAP. at ZERO VOLTS		ABSOLUTE MAX. RATING		DESCRIPTION DWG. No
		1] $t_{tr}$ (s)	2] $t_{rr}$ (s)	$V_r$ (V)	$I_f$ (A)	$Z_r$ ( $\Omega$ )	$I_r$ (A)	$C_{di/dt}$ (pF)	$R_L$ ( $\Omega$ )	$I_F$ (A)	$V_F$ (V)	$I_r$ (A)	$T$ (°C)	$V_r$ (V)	$I_r$ (A)	FWD I (A)	TEMP (°C)	
1N191	90	500n	30m	35	50k	$\emptyset$	$\emptyset$	$\emptyset$	15.0m	1.0	1500pF	30m	90A	Gal7	1A1by			

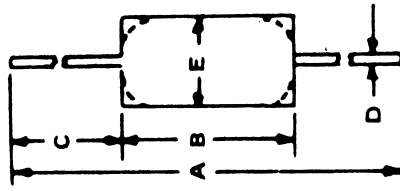

A	B	C	D	E
	.265 MAX	1.00 MIN	.020	.095 MAX

MAY SHOW COLOR BANDS TO DENOTE POLARITY.

